

SV200

INSTALLATION INSTRUCTIONS TILE ROOF

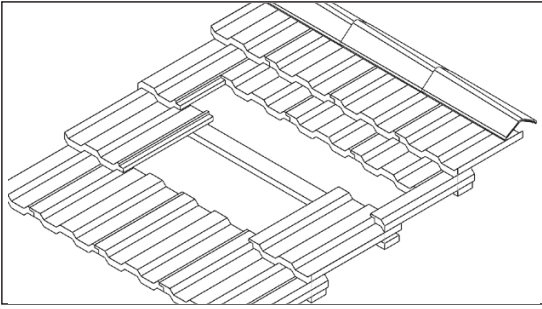

Step 1

Push back three tiles above the two tiles you have selected as install location.

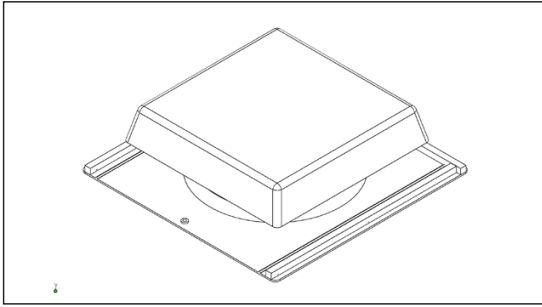

Step 2

Remove backing & place Foam Strip on the top and two sides of the Flange, ensuring to cover holes.

Note: Vent is positioned portrait - longer side running upward (see lines on flange).

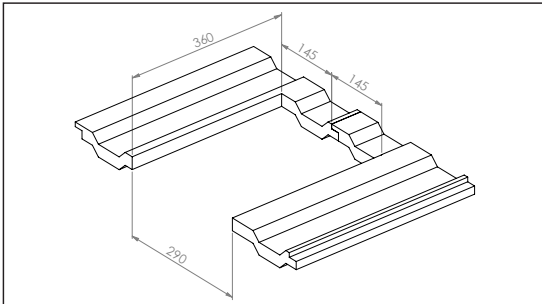

Step 3

Using an Angle Grinder, cut out an opening between the two tiles for the Vent.

From the bottom of each tile, cut up 360mm, 145mm in from the Vent edge.

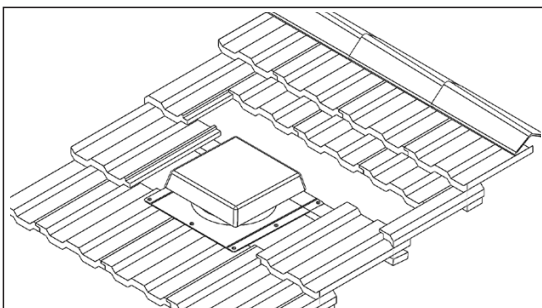

Step 4

Fix Vent to Batten using screw, so the Vent will accommodate cut tiles.

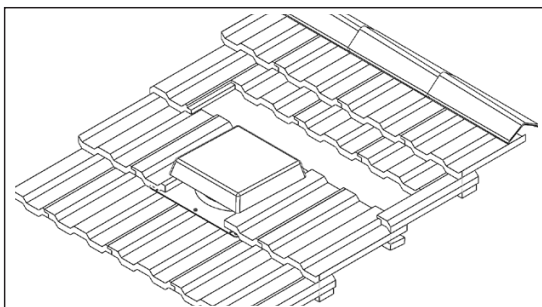

Step 5

Replace two cut tiles so surrounding Vent

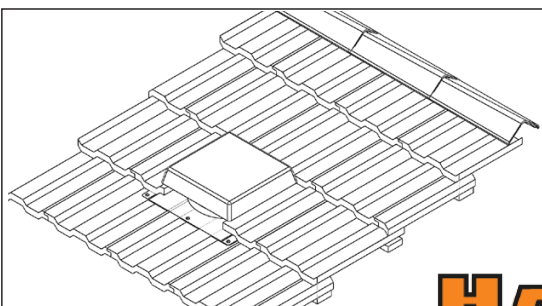

Step 6

Pull down top three tiles into original position.